



April 8, 2024

Jewell Jackson
Purchasing Manager
William Rainey Harper College
1200 W. Algonquin Road
Palatine, IL

RE: Harper College Project No. Q01151
2024 Sidewalk & Concrete Maintenance
Addendum #1

Jewell,

Please refer to the attached and below items regarding the proposed 2024 Sidewalk & Concrete Maintenance project by Harper College (project no. Q01151), which comprise **Addendum #1**. The Bid Documents for the project, dated March 28, 2024, shall be formally revised as described herein. Revised text in the Project Manual is denoted by ***bold-italics***; omitted text is denoted by ~~***bold-italics***~~. Receipt of this Addendum must be acknowledged by all prospective bidders within the applicable section on the Bid Form; failure to acknowledge receipt may result in disqualification of the bid.

The following responses are provided to questions/requests for information (RFI's) submitted by prospective bidders during the Non-Mandatory Pre-Bid Meeting for the project which was held on April 3, 2024, at 1:00PM:

1. Throughout the bid documents, references are made to concrete sidewalk "panels" – do these refer to separate lift-out sections of concrete pavement, or segments of concrete sidewalk between existing joints?
Response: All references to "panels" indicate segments of existing concrete sidewalk/pavements between joints; there are no separate "lift-out" sections of concrete pavement within the proposed areas of work.
2. Regarding the proposed paver replacement indicated on sheet C2.0 (on the south side of the HPC building), please confirm the design intent.
Response: The design intent is for the existing pavers to be fully removed and replaced with new concrete sidewalk as per the section detail on sheet C4.0, with the new sidewalk matching the existing extents and elevations of the pavers that will be removed.
3. Please confirm that all proposed replacement concrete is intended to match existing grades.
Response: Confirmed; all replacement concrete sidewalk/pavement shall match existing grades.
4. Regarding the proposed landscape area stripping and restoration indicated on sheets C1.11 and C1.12 (on the north side of Building H on the main campus), are there existing irrigation lines in place in that area? If so, how should those lines be addressed as part of the proposed work?
Response: There are existing irrigation lines in this area of work; additional notes have been added to sheets C1.11 and C1.12 to clarify how the existing irrigation shall be accommodated.



5. Please confirm that there are no modifications to the existing sewer connections being proposed as part of the utility structure rim adjustments as indicated on sheets C1.11, C2.0, and C3.0.
Response: Confirmed; there are no proposed modifications to the existing sewer pipe connections at these structures, only the structures themselves. Please also note that the sanitary manhole modification which was previously indicated on sheet C3.0 has been omitted from the scope of work.

In addition to the question responses provided above, the Bid Documents shall be revised as follows:

PROJECT MANUAL

No revisions/changes to Project Manual.

DRAWINGS

Sheets C1.11 and C1.12:

1. Clarify that existing irrigation system components in landscaped turf area shall be field-located and protected, with any incidental damages being repaired at no additional cost to Owner.

Sheet C3.0:

1. Omit manhole structure adjustment and associated regrading/landscape restoration in South Wolf Road public right-of-way to west of site.

Should you have any questions regarding the contents of this Addendum, please do not hesitate to contact me at abruder@cagecivil.com.

Yours truly,
CAGE ENGINEERING, INC.

A handwritten signature in black ink, appearing to read "Aaron J. Bruder", is written over a horizontal line.

Aaron J. Bruder, PE
Director of Engineering - Illinois

CC: Bidders of Record
JoAnn Martinez (Harper College)
Nathan Chung (Harper College)
Jennifer Kulbida (Harper College)
Steve Petersen (Harper College)

Attachments: Revised drawing sheets C1.11, C1.12, and C3.0

SEE SECTION 7

SEE SECTION 10

SEE SECTION 12

SEE SECTION 15

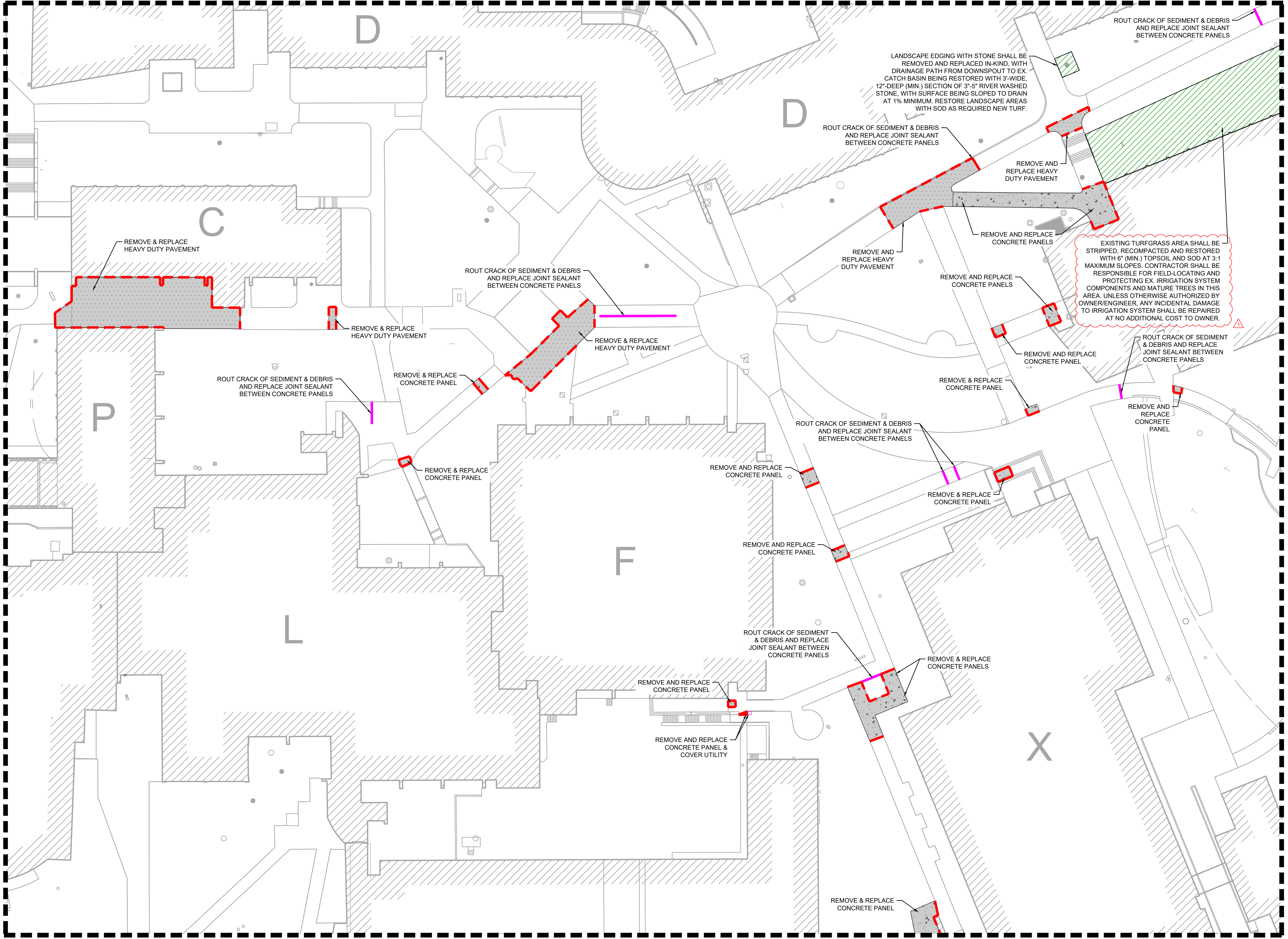

2200 CABOT DRIVE
 SUITE 325
 LISLE, IL 60532
 P. 630.598.0007
 WWW.CAGECIVIL.COM



REVISIONS

04/08/2024	ADDENDUM #1
03/28/2024	ISSUED FOR BID

HARPER COLLEGE PROJECT NO. 001151
2024 SIDEWALK & CONCRETE MAINTENANCE
 1200 W Algonquin Rd.
 Palatine, IL

PROJ NO: 230262
 ENG: HKC, SJS, AJB
 DATE: 03/28/2023

SHEET TITLE
SECTION 11 WORK PLAN

SHEET NUMBER
C1.11
 8 OF 14

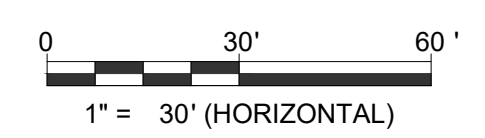

SEE SECTION 8

REMOVE AND REPLACE CONCRETE PANELS

EXISTING TURFGRASS AREA SHALL BE STRIPPED, RECOMPACTED AND RESTORED WITH 6" (MIN.) TOPSOIL AND SOD AT 3:1 MAXIMUM SLOPES. CONTRACTOR SHALL BE RESPONSIBLE FOR FIELD LOCATING AND PROTECTING EX. IRRIGATION SYSTEM COMPONENTS AND MATURE TREES IN THIS AREA. UNLESS OTHERWISE AUTHORIZED BY OWNER/ENGINEER, ANY INCIDENTAL DAMAGE TO IRRIGATION SYSTEM SHALL BE REPAIRED AT NO ADDITIONAL COST TO OWNER.

SEE SECTION 11

SEE SECTION 16

0 30' 60'
1" = 30' (HORIZONTAL)

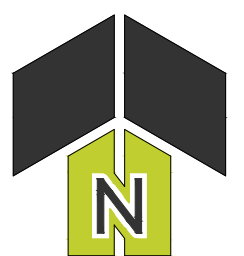

G

H

Lot 6

KRIS HOWARD DRIVE

2200 CABOT DRIVE
SUITE 325
LISLE, IL 60532
P. 630.598.0007
WWW.CAGECIVIL.COM



REVISIONS

04/08/2024
ADDENDUM #1
03/28/2024
ISSUED FOR BID

HARPER COLLEGE PROJECT NO. 001151
2024 SIDEWALK & CONCRETE MAINTENANCE
1700 W. Algonquin Rd.
Palatine, IL

PROJ NO: 230262
ENG: HKC, SJS, AJB
DATE: 03/28/2023

SHEET TITLE
SECTION 12
WORK PLAN

SHEET NUMBER
C1.12
9 OF 14

REVISIONS

NO.	DATE	DESCRIPTION
1	04/08/2024	ISSUED FOR BID
2	03/28/2024	ADDENDUM #1

HARPER COLLEGE PROJECT NO. 001151
2024 SIDEWALK & CONCRETE MAINTENANCE
 1200 W. Algonquin Rd., Palatine, IL

PROJ NO: 230262

ENG: HKC, SJS, AJB

DATE: 03/28/2023

SHEET TITLE

LCC WORK PLAN

SHEET NUMBER

C3.0

13 OF 14

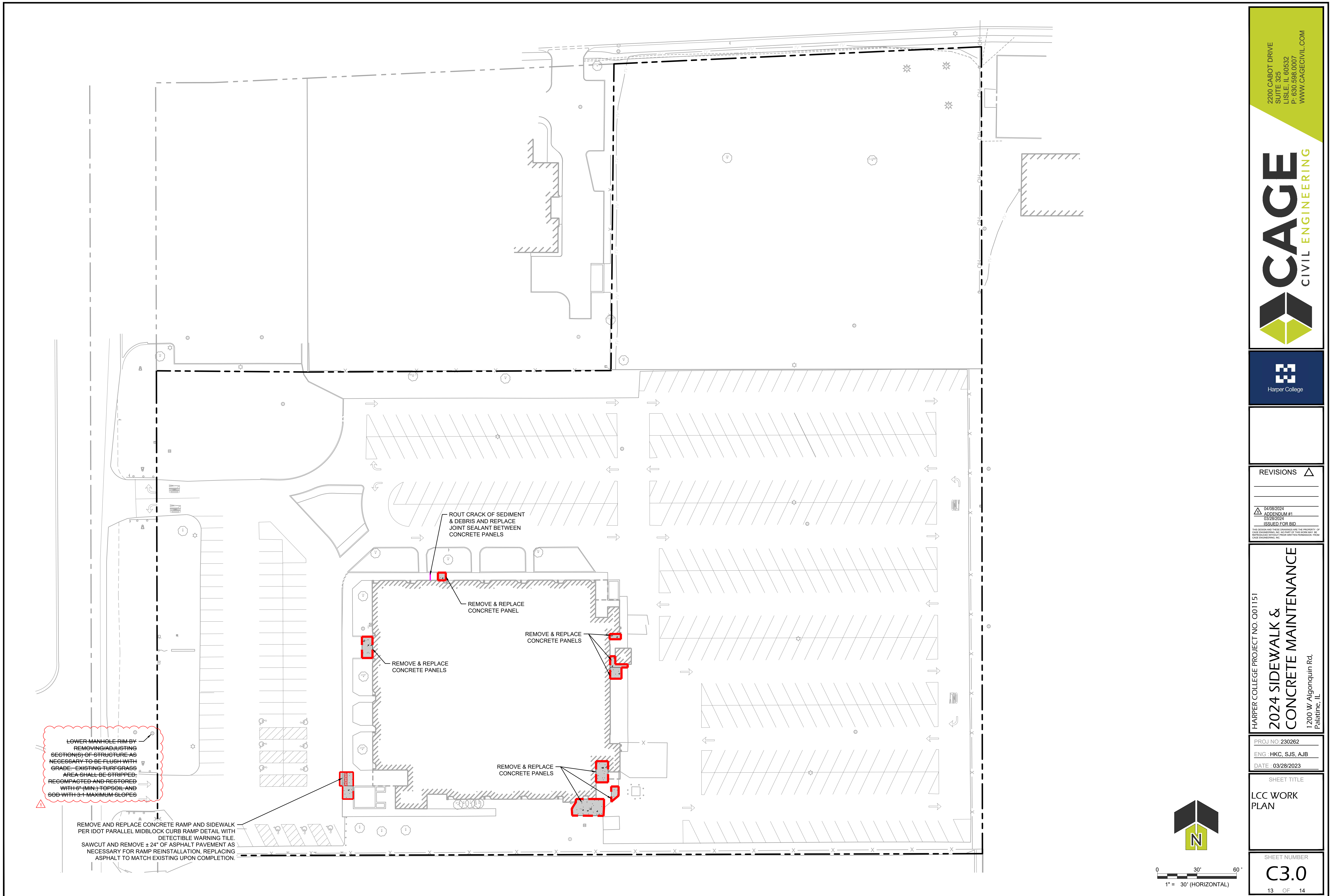

LOWER MANHOLE RIM BY REMOVING/ADJUSTING SECTIONS OF STRUCTURE AS NECESSARY TO BE FLUSH WITH GRADE. EXISTING TURF GRASS AREA SHALL BE STRIPPED, RECOMPACTED AND RESTORED WITH 6" (MIN.) TOPSOIL AND SOB WITH 3:1 MAXIMUM SLOPES

REMOVE AND REPLACE CONCRETE RAMP AND SIDEWALK PER IDOT PARALLEL MIDBLOCK CURB RAMP DETAIL WITH DETECTABLE WARNING TILE. SAWCUT AND REMOVE ± 24" OF ASPHALT PAVEMENT AS NECESSARY FOR RAMP REINSTALLATION, REPLACING ASPHALT TO MATCH EXISTING UPON COMPLETION.

ROUT CRACK OF SEDIMENT & DEBRIS AND REPLACE JOINT SEALANT BETWEEN CONCRETE PANELS

REMOVE & REPLACE CONCRETE PANEL

REMOVE & REPLACE CONCRETE PANELS

REMOVE & REPLACE CONCRETE PANELS

REMOVE & REPLACE CONCRETE PANELS

